

The PVC profiles are used for the installation of ETICS insulation system boards.



Item number	Name	Length	Package
1652279531	PVC base profile – 83	2m	5 pcs
1652279532	PVC base profile – 103	2m	5 pcs
1652279533	PVC base profile – 123	2m	5 pcs
1652279534	PVC base profile – 143	2m	5 pcs
1652279547	PVC base profile – 153	2m	5 pcs
1652279535	PVC base profile – 163	2m	5 pcs
1652279536	PVC base profile – 183	2m	5 pcs
1652279537	PVC base profile – 203	2m	5 pcs

MATERIAL:

The profiles are made from high-quality, tough, regranulated PVC that is highly resistant to alkalis and UV radiation. Modern PVC does not contain lead stabilisers.

ADVANTAGES OF PVC:

- elimination of a thermal bridge where the ETICS system is installed
- mechanical resistance
- increased service life where the ETICS system is installed
- dimensional stability of the profile

USE:

- in-plane installation of insulation material
- aesthetically perfect finishing of the visible plinth on the building
- prevention of rising damp, effective drainage of water from the ETICS surface
- protection of the system against mechanical damage

INSTALLATION INSTRUCTIONS:

Place the PVC profile against the wall at the place of installation. Use a spirit level to level the profile and mark the places where holes for dowels will be drilled. Drill into hollow aerated concrete bricks without a hammer. Anchor the profile to the wall with at least 3 pcs/m (if distance washers are used, the anchoring elements are installed in these places). Insert the dowel through the hole in the PVC profile into the pre-drilled, sufficiently deep and clean hole in the masonry. Anchor the profile by hammering a steel expanding mandrel into the dowel. If there is any unevenness on the wall at the place of installation, use distance washers under the profile. The profiles are connected to each other by plinth connecting profiles. To connect them at corners, cut the profiles at a 45° angle.

CONDITIONS OF USE:

The PVC profiles must not be installed at an air temperature and wall surface temperature below 5°C and above 30°C. Throughout the installation and the final surface treatment curing, the profile must be protected from direct sunlight and weather exposure.

PACKAGING AND STORAGE:

Secured with cable ties; storage and transportation in a dry covered place at temperatures between 5°C and 30°C in a horizontal position.

PVC BASE PROFILE

TECHNICAL SPECIFICATIONS OF PVC PROFILE:

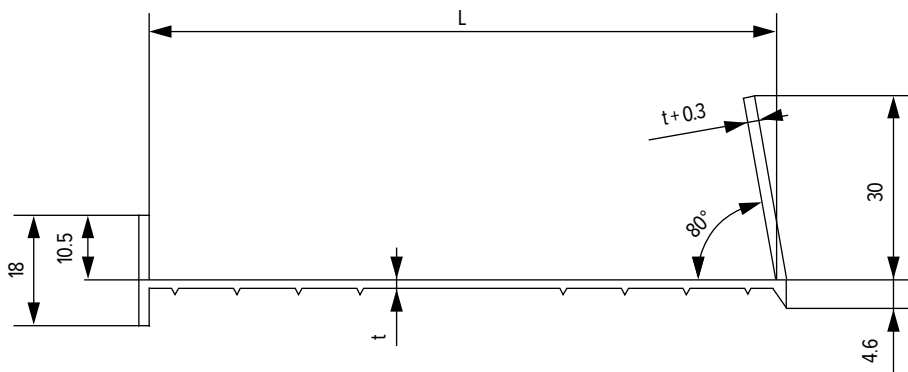

L (mm)	t (mm)
83	1.5
103	1.65
123	1.8
143	1.95
153	2.1
163	2.2
183	2.3
203	2.4

RECOMMENDED SYSTEM ACCESSORIES FOR PVC PROFILE:

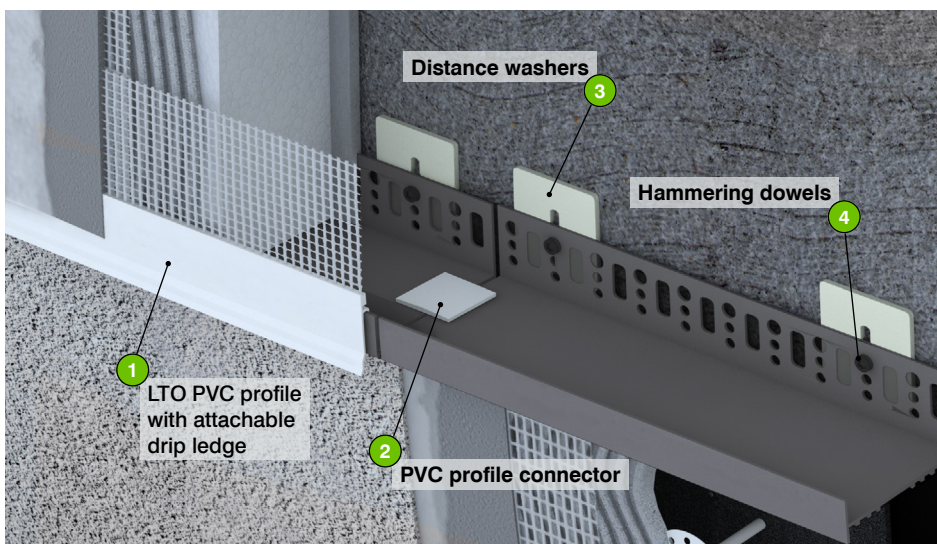

- 1 LTO PVC profile with attachable drip ledge
- 2 PVC profile connector
- 3 Distance washers
- 4 Hammering dowels

For increased water drainage in the vertical direction and to prevent the formation of horizontal cracks and fissures, an LTO PVC profile with an attachable drip ledge and fabric, or an attachable drip ledge and double fabric, must be used.

This visualization is for illustrative purposes only.

Item number	Name	Length	Package
1650400066	LTO PVC profile with attachable drip ledge	2.5m	25 pcs
1652279546	LTO PVC profile with attachable drip ledge and double fabric	2.5m	25 pcs
1652279538	PVC profile connector	1m	1 pc
1650400013	Profile distance washer	2mm	50 pcs
1650400014	Profile distance washer	3mm	50 pcs
1650400015	Profile distance washer	4mm	50 pcs
1650400016	Profile distance washer	5mm	50 pcs
1650400017	Profile distance washer	8mm	50 pcs
1650400018	Profile distance washer	10mm	50 pcs



REGISTERED OFFICE: RETEK s.r.o.
Tiskařská 257/10
108 00 Praha 10
Czech Republic

MANUFACTURE: RETEK s.r.o.
U Nádraží 140
751 21 Prosenice
Czech Republic

www.retek.cz